

2 Angela

Table of Contents

- | [Property Details](#)
- | [Photo Gallery](#)
- | [Map](#)
- | [Contact For Inspection](#)

Property Details

2 Angela Place, EAST LISMORE



SOLD BY THE WAL MURRAY TEAM

4  2  2 

This home is located in such a great position of East Lismore, making it close to golf course, St Vincents Hospital, East Lismore shopping centre, schools, bowls/tennis clubs and 3km to Southern Cross University.

The home captures magnificent northerly views looking over Lismore and out to the hills, giving some of the best views in the area. Sit back and relax while living in a quiet street, this single level home will suit many buyers, from retirees to families.

The home features 4 bedrooms, all with built-in robes, main has an ensuite and walk-in robe. The home has been designed with an open plan lounge and dining area with the adjacent family room giving extra space. With the north facing aspect, these living areas capture the northerly views and flow outside to the covered patio. The central kitchen has plenty of cupboard space and a large walk-in pantry. Ducted air-conditioning has been installed throughout the house giving comfort all year round.

Another bonus with this property is the ability to park a van/trailer/boat to the side of the home. Currently vacant, this property is ready for you to move in. Call today.

- 4 Bedrooms
- 2 Bathrooms
- 2 Garages
- Ducted Cooling
- Ducted Heating
- Remote Garage
- Deck
- Built In Robes
- Dishwasher

\$675,000

Photo Gallery



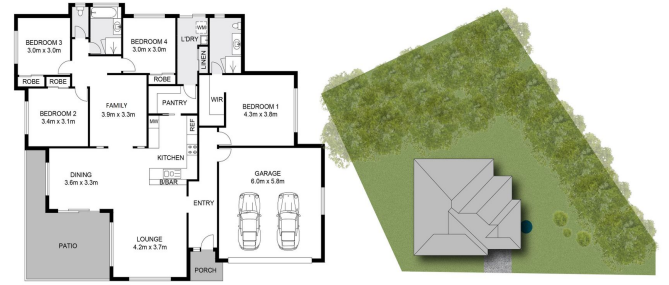

SITE PLAN

Scale in meters, indicative only. Dimensions are approximate. All information contained herein gathered from sources we believe to be reliable. However we cannot guarantee its accuracy and interested persons should rely on their own inquiries. © www.mediashow.com

INT : 163.25m²
 EXT : 24.05m²
 GARAGE : 38.64m²

2 Angela Place, East Lismore



Map



Contact For Inspection



BENJAMIN CONTE

LICENSED REAL ESTATE AGENT

0408 368 913

ben@walmurray.com.au